

# THE “DORMITORY CITY” TRANSFORMATION

BOSTON - SARAJEVO

## WINDOW 2

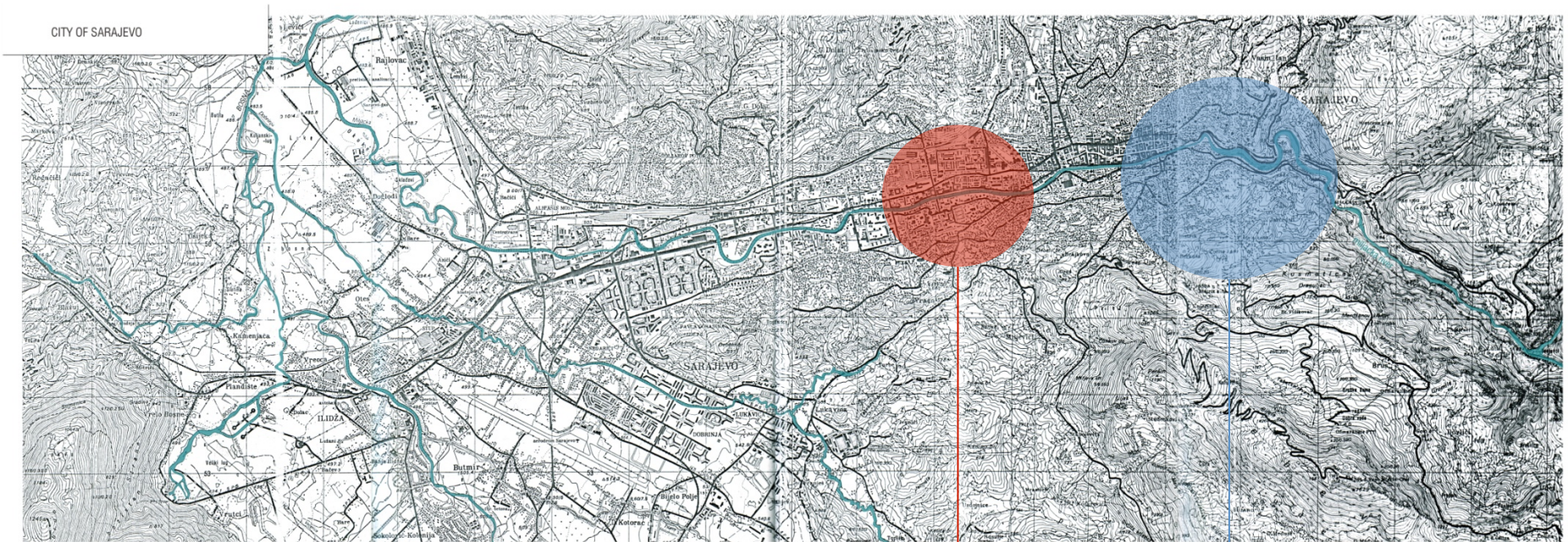



SECONDARY CITY CENTER

PRIMARY CITY CENTER

LOCATION - FRAME 2

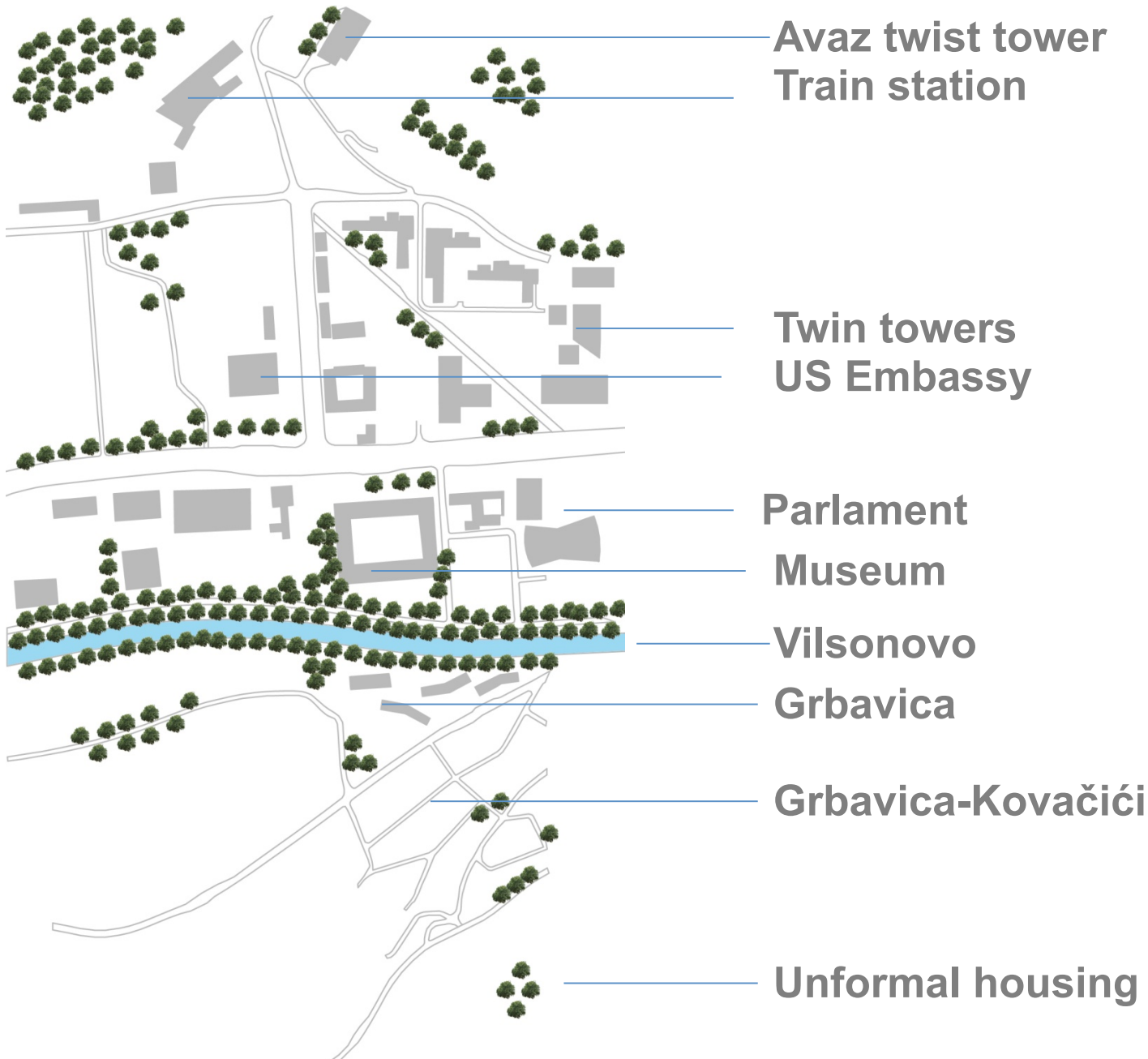

Avaz twist tower  
Train station

Twin towers  
US Embassy

Parlament  
Museum

Vilsonovo  
Grbavica

Grbavica-Kovačići

Unformal housing



**Train station**

**Campus - Embassy**

**Museum - Shopping**

**Pedestrian zone**

**Grbavica**

**Grbavica - Kovačići**

**Unformal housing**

**LOCATION - FRAME 2**



FLOW OF PERCEPTION

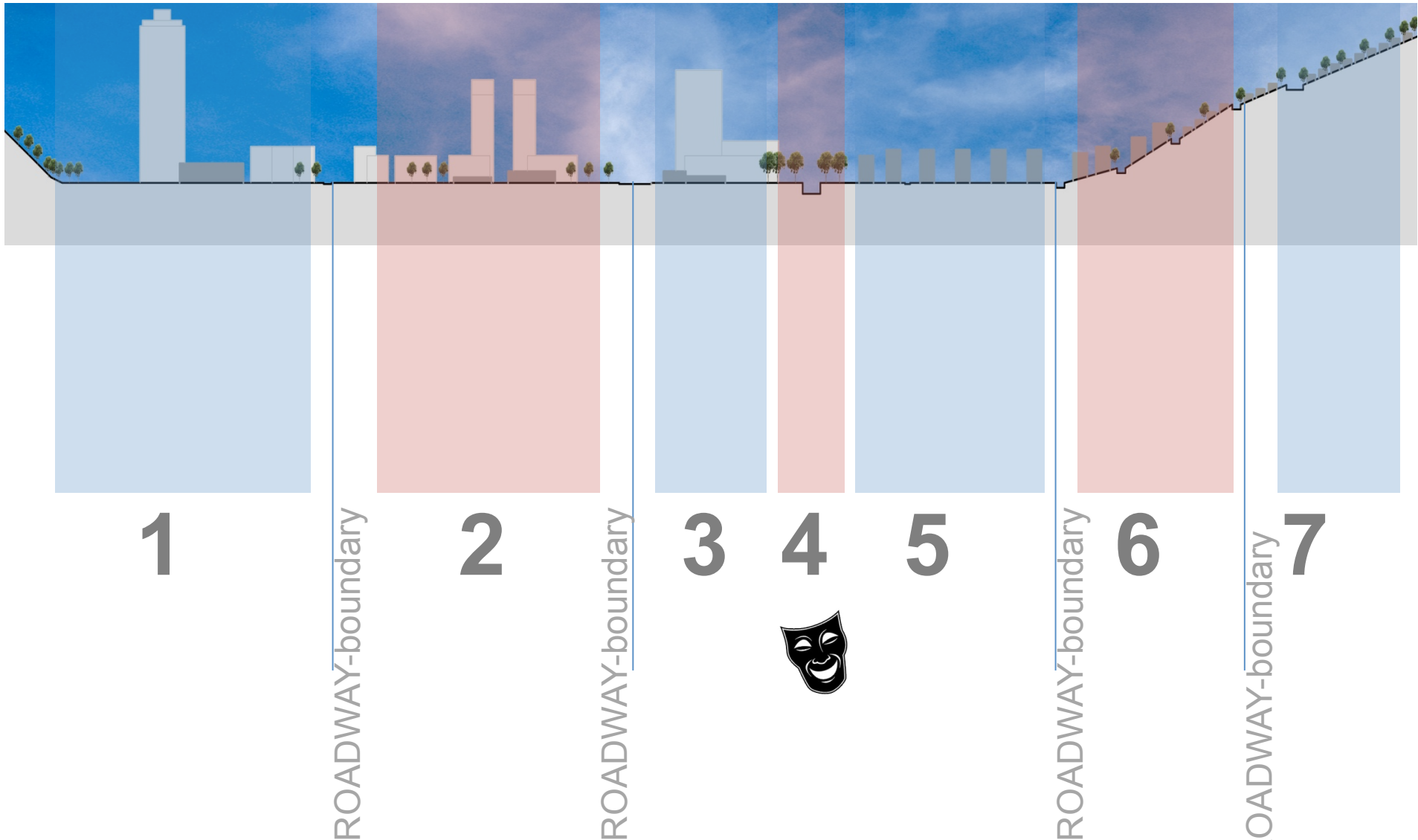

SECTION 1-1

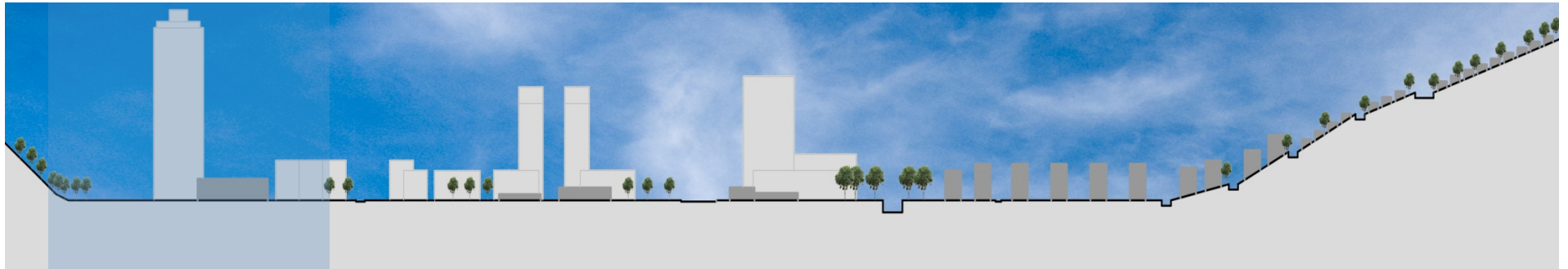

Marker: **Train station**  
Potentially good space

1

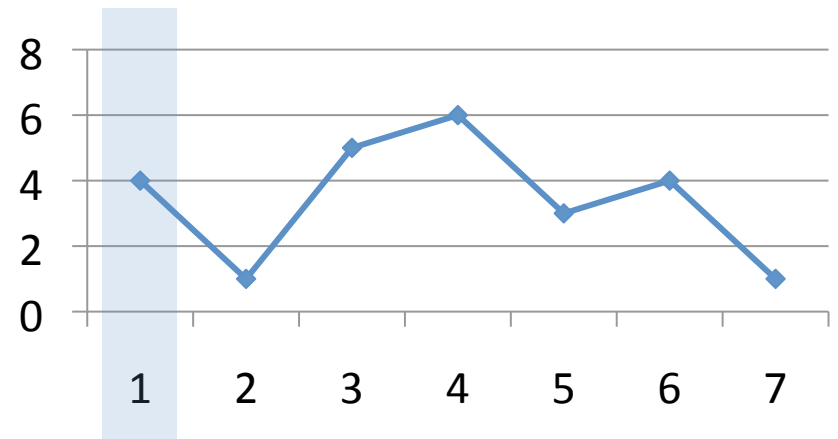

How can this potentially good space be transformed into a public area that can correspond to the rest of the area?

concentration-nice space-disjointed-feeling:seclusion

**LAYER 1**

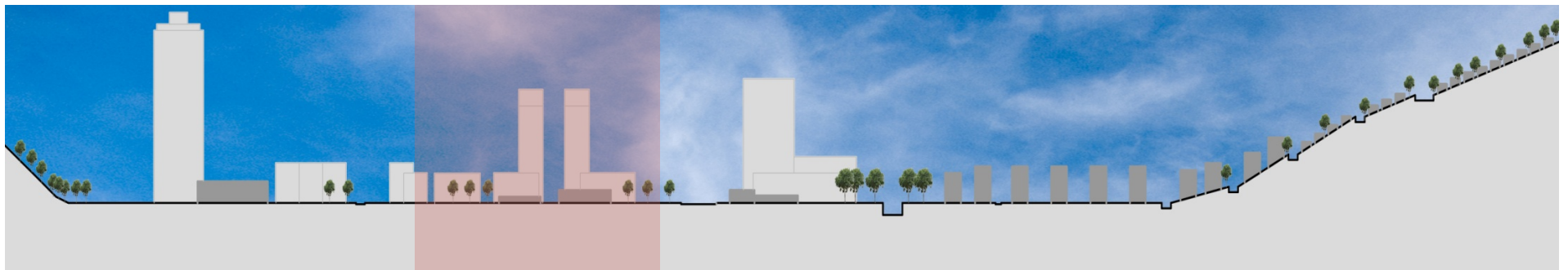

2

Marker: **US Embassy**

Potentially good space

How has the location of the embassy effected the urban harmony of the frame?

How can the embassy be emprowed to fix the bad feeling it's creating?

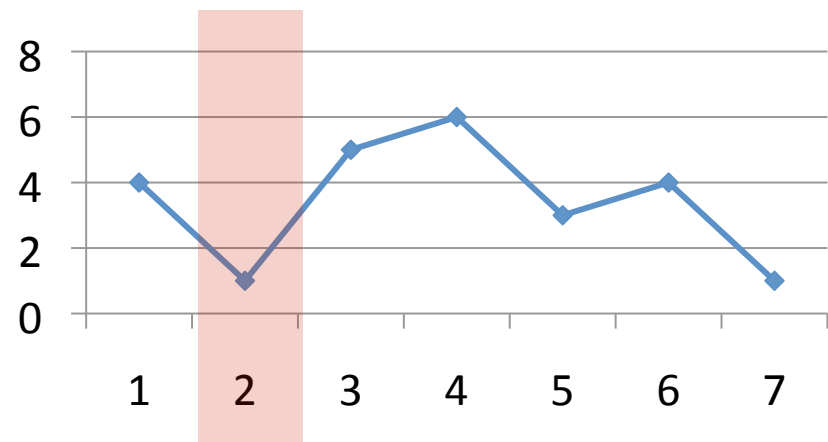

Not belonging-unsafe-bad space-disjointed-feeling:seclusion

**LAYER 2**



Marker: **Museum, Shopping**

Potentially good space

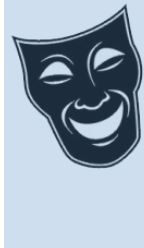

**3**

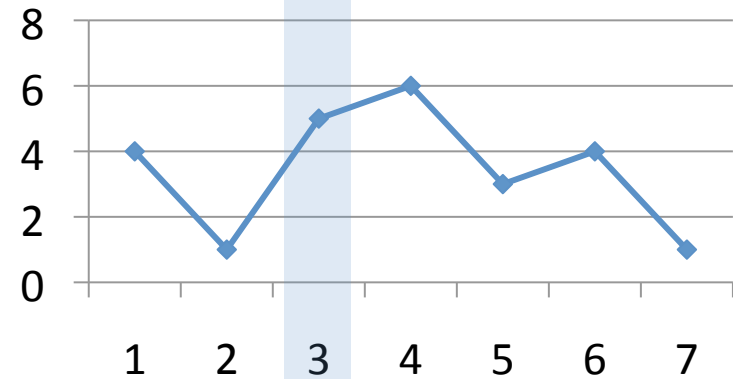

In which way can we link this potentially good layer with it's different qualities of buildings from the Austrian period to the moder architecture?

Potentially good space-important layer-good feeling

**LAYER 3**



Marker: Vilsonovo  
-pedestrian zone-



4

Question of using the great qualities of  
this space and to implement it's feelings  
in the rest of the window!

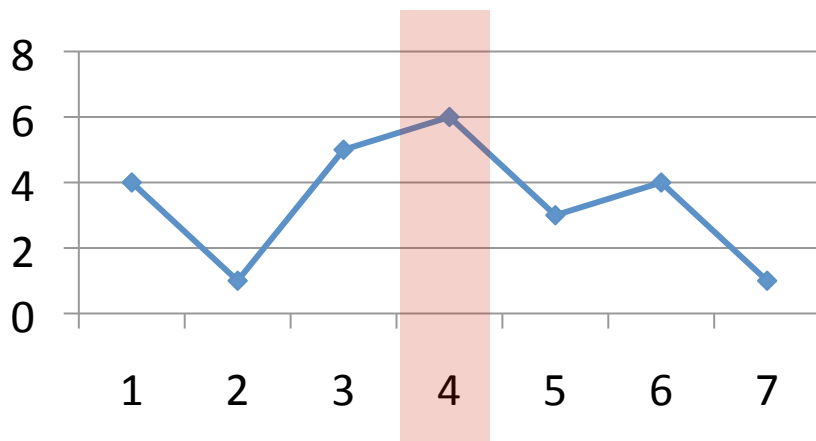

human scale-quiet-peaceful-harmonious link

**LAYER 4**

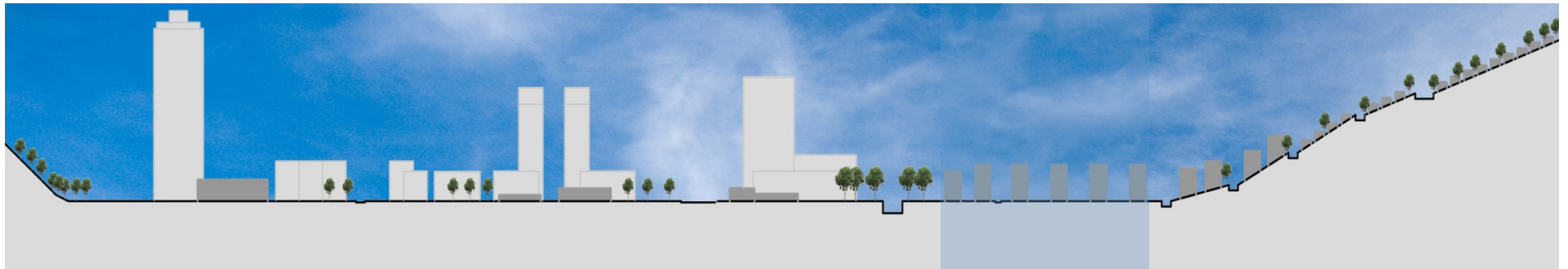

Marker: **Grbavica**

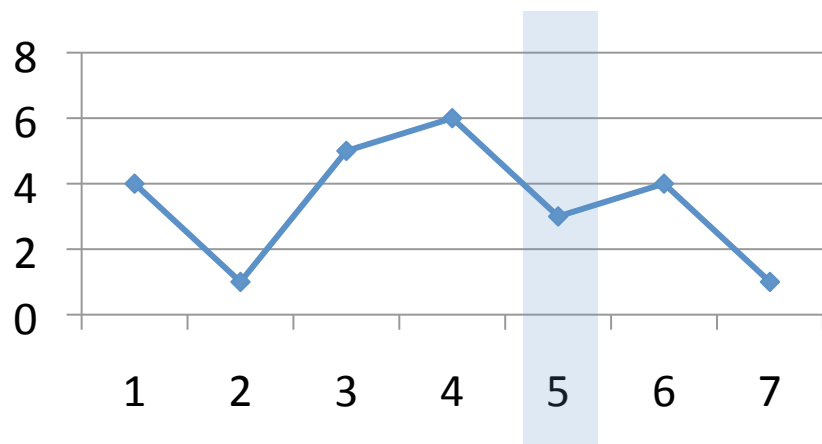

How do the pedestrians feel about the scale of the building?

How can we make a better connection of this area to the pedestrian zone?

large scale-community housing-bad/lack of human scale

**LAYER 5**

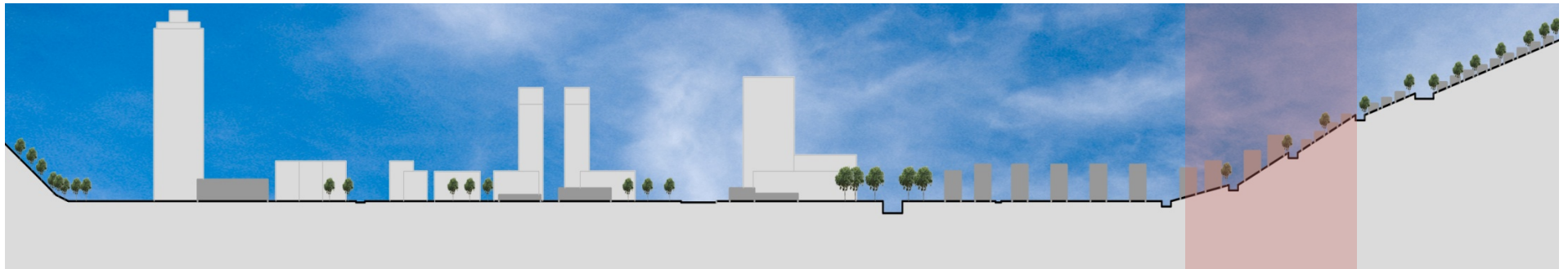

Marker: **Grbavica-Kovačići**

**6**

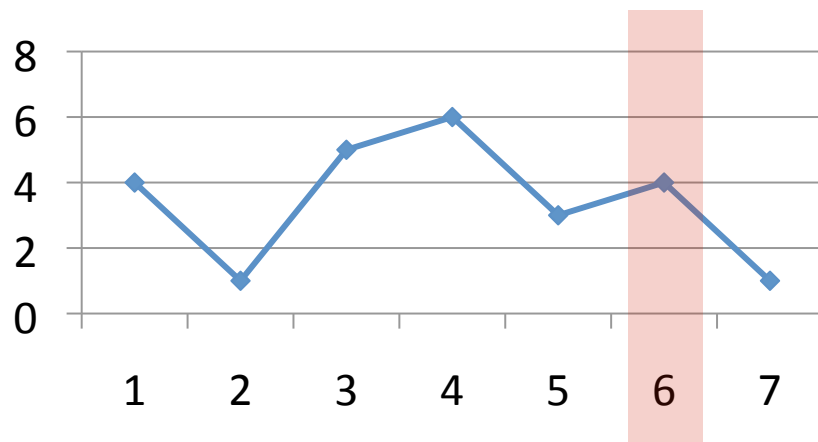

How can we turn this active area with a human scale into a connection between the informal living and the large scale building of Grbavica?

human scale-active streets-good feeling

**LAYER 6**

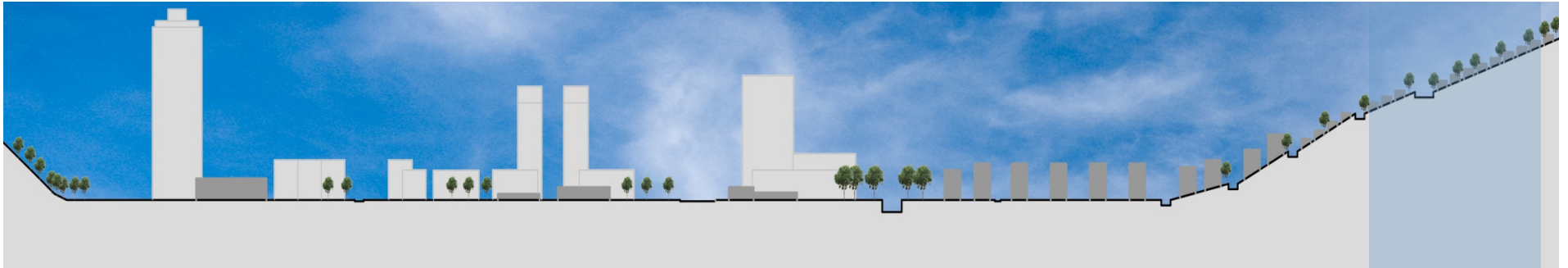

Marker: **Unformal** housing

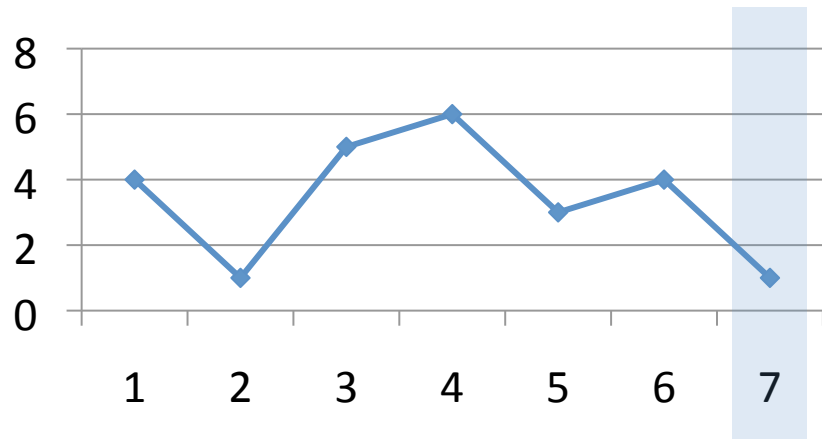

7



What can we do to make the segregated/  
cramped space feel more comfortable  
and connected to the rest of the  
window?

cramped-segregated-good & bad qualities

**LAYER 7**

**RE-CONNECTION??**

**MAIN QUESTION?**

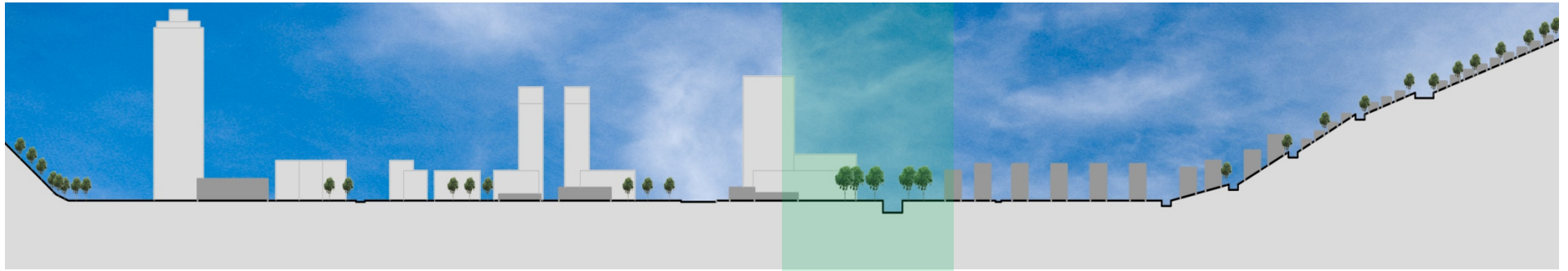

**LINK**

- BETTER CONNECTION FROM THE PADESTRIAN ZONE TO THE TRAIN STATION.
- NEW URBAN MOBILIAR AND ARCH. INSTALATIONS TO ENRICH THE ENVIRONMENT.
- REDESIGN OF THE PADESTRIAN ZONE AROUND THE AMERICAN EMBASSY.
- TRY TO REDIRECT SOME ROADWAYS TO EMPROVE THE TRANSPORTATION SISTEM IN THE AREA.

**Re**-connection based on creating free space for the padestrian and achieving a more enjoyable feeling for every user. This space should be used as branches for connecting different functions of the frame.

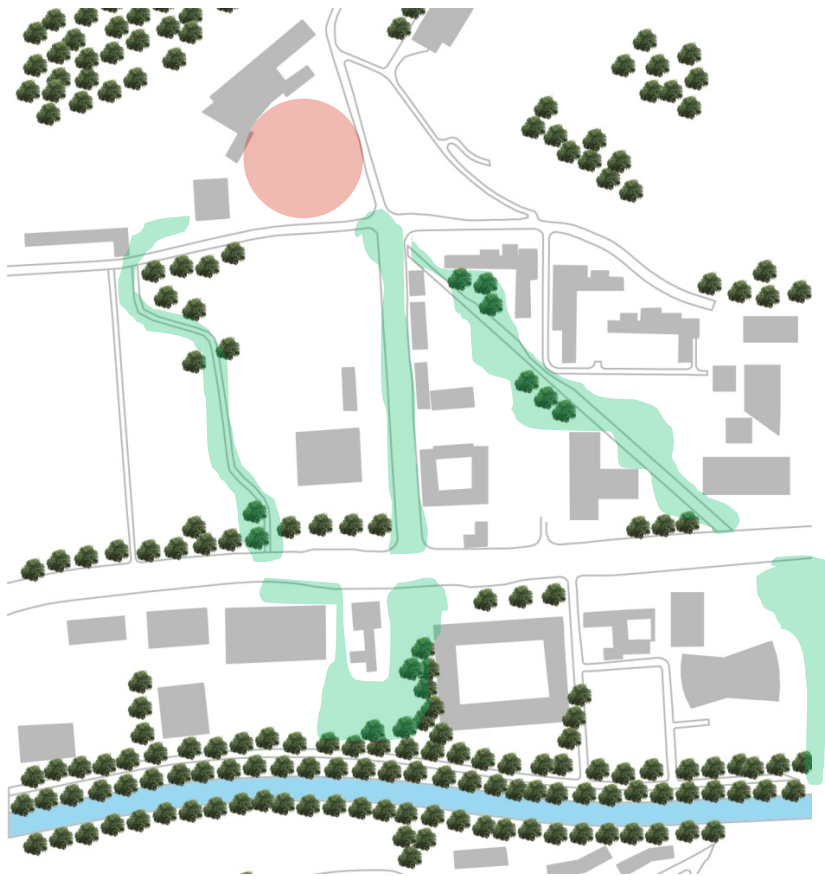

**RE-CONNECTION**

**PROPOSAL**

**THANK YOU**



Polić Ajdin

Anthony Cavalieri

Chelsea McCosh